

**JOHN KOTT'S**  
BOOK 5347, PAGE 311  
TAX MAP 22, LOT 33

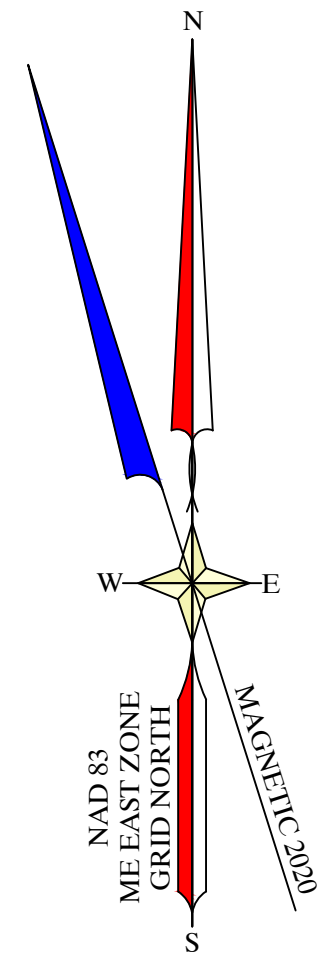

LEGEND	
	EXISTING CONTOUR
	SPOT ELEVATION
	BOULDER
	DECIDUOUS TREE

**GENERAL SITE NOTES:**

- 1) LOT INFORMATION:  
PHYSICAL ADDRESS:  
171 CALDERWOOD LANE, ROCKPORT, ME.,  
LOT AREA: ±7.3 ACRES  
TAX MAP: 22, LOT: 33  
DEED: BK. 5347 PG. 311
- 2) OWNER & APPLICANT:  
JOHN KOTT'S  
3737 WILLOWICK RD HOUSTON, TX, 77019
- 3) ENGINEER & SURVEYOR:  
GARTLEY & DORSKY ENGINEERING & SURVEYING INC.  
59 UNION STREET UNIT 1, P.O. BOX 1031, CAMDEN, ME, 04843  
(207) 236-4365
- 4) NOTES:  
MARINE CONTRACTOR: PROCK MARINE COMPANY, 67 FRONT STREET ROCKLAND, ME 04841

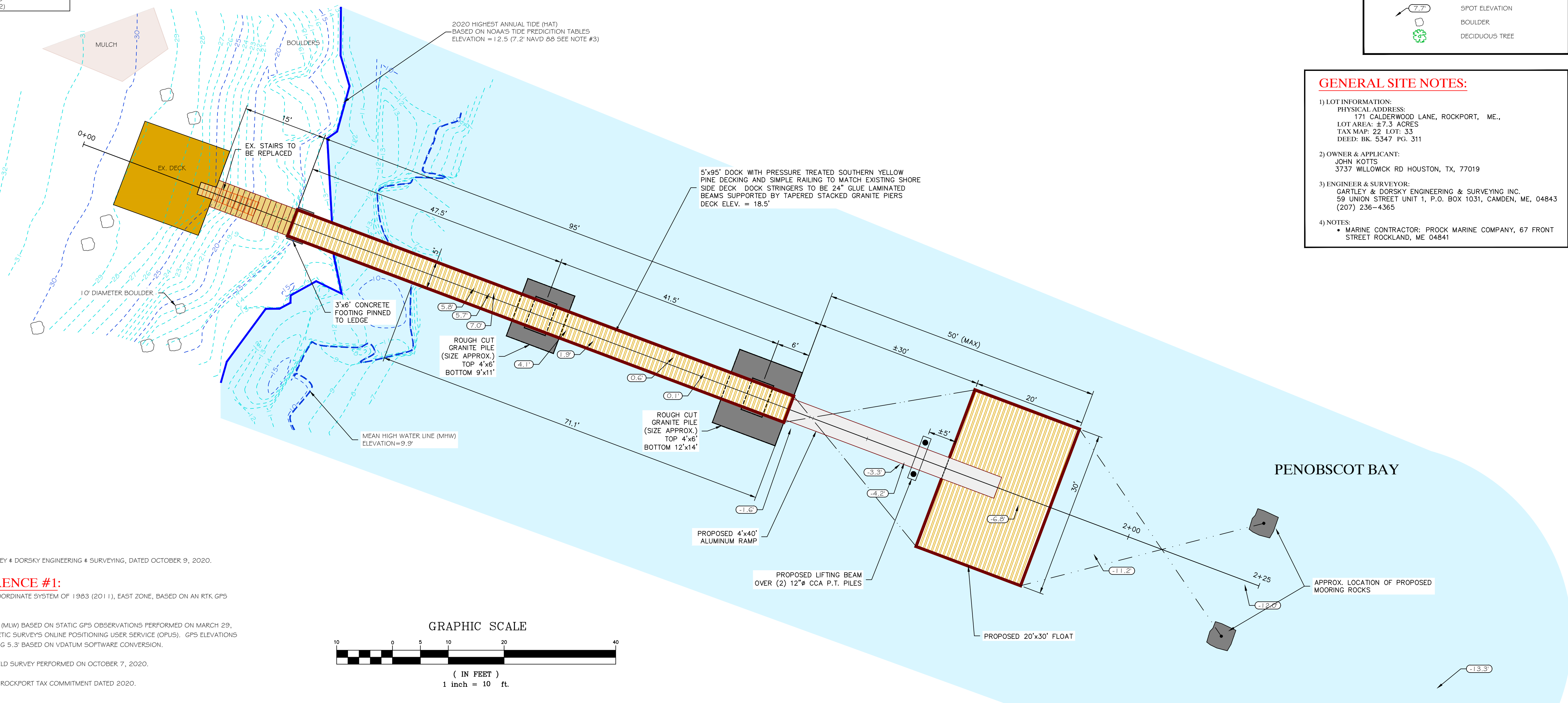

**PLAN REFERENCES:**

- 1) "TOPOGRAPHIC SURVEY, PROCK MARINE," BY GARTLEY & DORSKY ENGINEERING & SURVEYING, DATED OCTOBER 9, 2020.

**NOTES FROM PLAN REFERENCE #1:**

- 1) PLAN ORIENTATION IS REFERENCED TO THE MAINE COORDINATE SYSTEM OF 1983 (2011), EAST ZONE, BASED ON AN RTK GPS SURVEY.
- 2) ELEVATIONS ARE REFERENCED TO MEAN LOW WATER (MLW) BASED ON STATIC GPS OBSERVATIONS PERFORMED ON MARCH 29, 2017 AND PROCESSED THROUGH THE NATIONAL GEODETIC SURVEY'S ONLINE POSITIONING USER SERVICE (OPUS). GPS ELEVATIONS WERE ADJUSTED FROM NAVD 1988 TO MLW BY ADDING 5.3' BASED ON VDATUM SOFTWARE CONVERSION.
- 3) THIS PLAN IS THE RESULT OF AN ON THE GROUND FIELD SURVEY PERFORMED ON OCTOBER 7, 2020.
- 4) OWNER INFORMATION IS TAKEN FROM THE TOWN OF ROCKPORT TAX COMMITMENT DATED 2020.

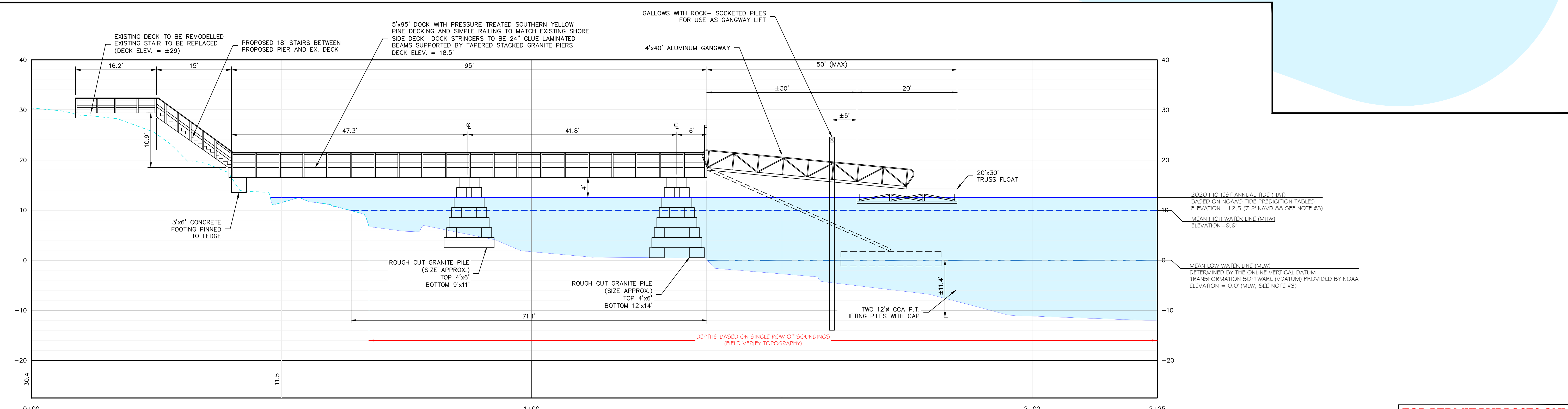
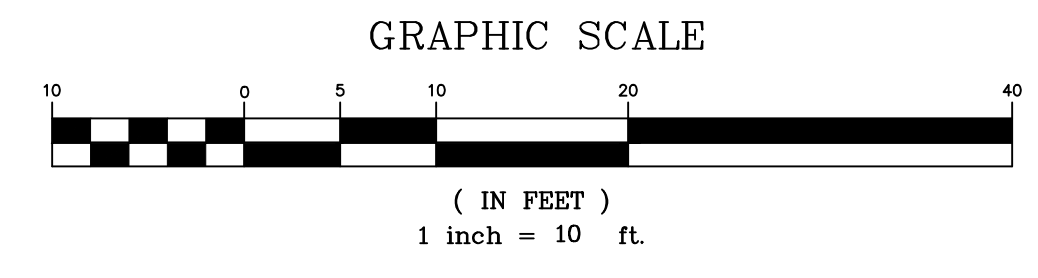

**PIER PROFILE**  
SCALE: 1" = 10'

**FOR PERMIT PURPOSES ONLY**  
**NOT FOR CONSTRUCTION**

CLIENT/PROJECT:	PROCK MARINE KOTT'S PIER	SHEET TITLE:	PIER PLAN	DATE:	NOVEMBER 13, 2020	REVISED RAMP LENGTH AND FLOAT LOCATION	12/2/20
	LOCATION: 171 CALDERWOOD LANE		SCALE: 1" = 10'		NO.		1
TOWN:	ROCKPORT	COUNTY:	KNOX	STATE:	MAINE	DRAWN BY:	AW
						CHECKED BY:	JAD

PROJ. NO. 2020-250

**C1**

**Gartley & Dorsky**  
ENGINEERING SURVEYING

59 Union Street, Unit 1, P.O. Box 1031, Camden, ME 04843-1031  
Ph: (207) 236-4365 Fax: (207) 236-3055 Toll Free: 1-888-282-4365  
165 Main Street, Suite 210 P.O. Box 1072, Damariscotta, Maine 04845  
Ph: (207) 790-5005

